

(1)	(2)	(3)	TM9-2320-211-34P			(4)	(5)	(6)	(7)	(8)	(9)	(10)
SMR	Federal	DESCRIPTION	UNIT	QTY	30	Days	30	Days	30	Days	plus	on
Code	Stock	Number	meas	of	inc.	allowance	allowance	allowance	alw	maint		
			in	in					per	alw		
			Unit						100	per	(a)	(b)
									equip	100	Figure	Item
									cnt-	equip	No.	No.
		Reference Number & Mfr. Code	Usable On Code		(a)	(b)	(c)	(a)	(b)	(c)		
					1-20	21-5(51-10)	1-20	21-5(51-10)	1-20	21-5(51-10)	gcy	
		1812-SPECIAL PURPOSE BODIES--CONTINUED NON-ILLUSTRATED--CONTINUED										
P-F	5930-679-15	SWITCH,PUSH:SOLID SIDE 8342288 (19207)	CE,CF,CG	EA	2	*	*	*	*	*	6	8
P-O	5975-335-25	TUBE,FLEXIBLE,NONMETALLIC: 8376125 (19207)	CE,CF,CG	FT	V	*	*	*	*	*	3	5
		GROUP 20-HOIST,WINCH AND POWER CONTROL AND POWER TAKE-OFF										
		2001-HOIST,WINCH,CRANE ASSEMBLY										
P-O-R	2590-741-11	WINCH ASSEMBLY:FRONT 7411122 (19207)	HA,JA,FJ	EA	1	*	*	*	*	*	6	10 208 1
P-F	2590-121-07	SHEAVE ASSEMBLY,WINCH: 7954483 (19207)		EA	1	*	*	*	*	*	4	5 208 2
P-F	5305-054-92	SCREW,CAP,HEXAGON HEAD: TRACK ASSEMBLY MS51955-77 (96906)		EA	2	*	*	*	*	*	6	10 208 3
P-F	5310-834-87	NUT,PLAIN:TRACK ASSEMBLY MS356919-33 (96906)		EA	4	*	*	*	*	*	6	10 208 4
P-F	5305-044-55	SCREW,CAP,HEXAGON HEAD: MS90725-160 (96906)		EA	1	*	*	*	*	*	6	10 208 5
P-F	5310-820-66	WASHER,LOCK:TRACK ASSEMBLY MS35338-50 (96906)		EA	1	*	*	*	*	*	6	10 208 6
X1		TRACK ASSEMBLY: 8344234 (19207)			1							208 7
P-O	2590-641-64	WINCH,ASSEMBLY:WITH ROLLER 7412382 (19207)	HA,JA,FJ	EA	1	*	*	*	*	*	6	10 208 8
P-F	2590-118-55	DRUM ASSEMBLY,WINCH: 7954477 (19207)		EA	1	*	*	*	*	*	4	5 208 9
P-F	5305-051-08	SCREW,CAP,HEXAGON HEAD: ROLLER ASSEMBLY MS90725-164 (96906)		EA	4	*	*	*	*	*	6	10 208 10
P-F	5310-820-66	WASHER,LOCK:ROLLER ASSEMBLY MS35338-51 (96906)		EA	4	*	*	*	*	*	6	10 208 11
P-F	5310-584-78	WASHER,LOCK:ROLLER ASSEMBLY MS35338-51 (96906)		EA	12	*	*	*	*	*	6	10 208 12
P-F	5310-584-78	WASHER,LOCK:ROLLER ASSEMBLY MS35338-51 (96906)		EA	12	*	*	*	*	*	6	10 208 12
P-F	5305-939-92	SCREW,CAP,HEXAGON HEAD: ROLLER ASSEMBLY MS90725-187 (96906)		EA	12	*	*	*	*	*	6	10 208 13

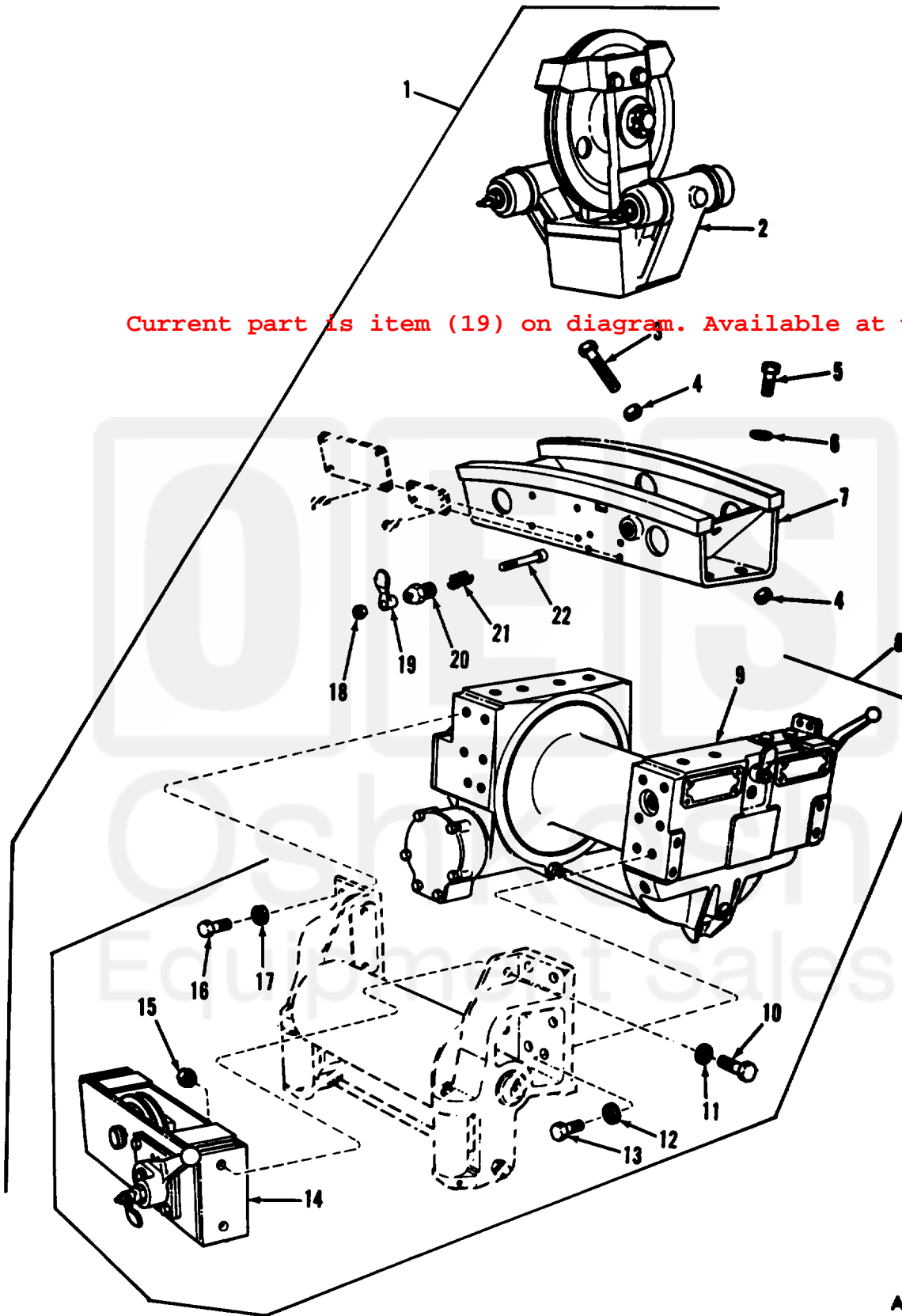

Current part is item (19) on diagram. Available at [www.oshkoshequip.com](http://www.oshkoshequip.com)

AT 47303

Figure 208. Front winch assembly.

Current part is item (19) on diagram. Available at [www.oshkoshequip.com](http://www.oshkoshequip.com)